

**B.**

**RECORD CARD FOR SECULAR MONUMENTS.**

(N.B.—Detail of special interest is to be entered here, but described fully on a separate card.)

1. Name and situation of Monument (with owner's Name and Address). *Pontymoody*

*3/4 mile E of Church.*

2. General appearance: (a) No. of storeys. *2 rattle.*

(b) Building materials. *Stone rubble.*

(c) Roofs. *Mod. slates.*

3. Historical development (with dates and small sketch plan).

*A mid 17th c. house. The N.E. portion of which is now used as a barn but which originally formed part of dwelling house. c. 1700 the wing was added. In modern times a stable has been built on against S.E. wall of barn.*

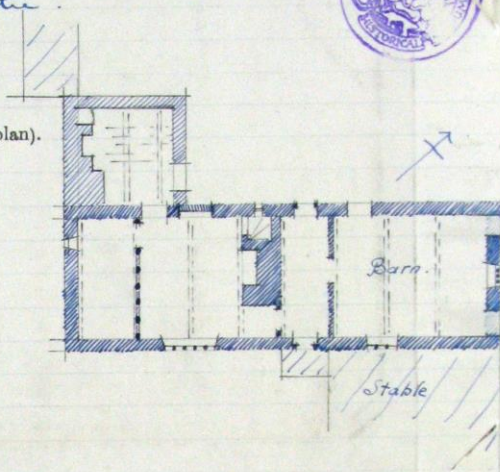

4. Special features (if any).

5. Elevations: (Beginning with the main front, and mentioning, in the following order:—(a) Walls; (b) Gables; (c) Doors; (d) Windows; (e) Chimneys; (f) Rainwater heads and pipes.)

*S.E. Elev. Stone rubble. Downway has a moulded wood frame. In ground floor is a three light partially blocked window & a 5 light transomed window with moulded frame & mullions of section. Within modern stable there is on this S.E. wall a 3 light window with moulded frame & mullions as in window already described.*

*N.E. Elev. Gabled. Two downways the main N. of which has a stop chamfered frame, while between these is a 4 light diamond mullioned window.*

*N.W. Elev. Stone. Downway with stop chamfered detail. On ground floor is a blocked window while on 1st floor is a two light window with moulded frame & mullion. The wall to barn has been partly re-built. Wing is gabled.*

*S.W. Elev. Gabled. Gable partly re-built. There is a blocked gable in wing.*

6. Grounds: (a) Gardens; (b) Outbuildings; (c) Statuary, sundials, etc.

*Re-set in N.E. wall of stable are 2 window frames with moulded frames & mullions uniform with those in house.*

County. *Herefordshire*  
 Parish. *Llanveynoe*  
 Sub-Commission. *Seaton*  
 No. of Monument. *1*



7. Interior: (Disposition of rooms, if original, giving fittings as they occur (see list), beginning with the ground floor, following with the basement, and working up to the attics; staircases in the same manner.)

**Fittings:**

(Reminder list.)

(1) C

(2) C

(3) D

(4) F

(5) G



(6) Paintings.

(7) Panelling.

(8) Parquetry and floors

(9) Plasterwork on internal walls.

(10) Roofs and beams (internal).

(11) Screens.

(12) Tapestries.

(13) Miscellaneous (e.g., carving, ironwork, locks, &c.).

Between room & dining is a panelled partition with stop chamfered posts. In same is doorway with segmental head.

Ceilings of ground floor rooms have exposed stop chamfered beams. Ceiling joists are exposed in the wing.

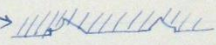
In main room there is a cupboard with battened door with moulded planks >  c. 1700.

8. Condition: Fair.

9. Visited by (with dates): A.T. Phillips. May. 1927.

10. Bibliography:

11. No. of Ordnance Sheet (6-in.): XLIII. N.E.

12. Signature of Investigator: A.T. Phillips





ings.

inder list)

ings:

CJP.182.