

B.

RECORD CARD FOR SECULAR MONUMENTS.

(N.B.—Detail of special interest is to be entered here, but described fully on a separate card.)



County. *Herefordshire*
 Parish. *Llanveynoe*
 Sub-Commission. *Secular*
 No. of Monument. *15*

1. Name and situation of Monument (with owner's Name and Address). *Olchon House in Olchon Valley not quite 1 mile S.S.E of Church.*
2. General appearance: (a) No. of storeys. *2 attic*
 (b) Building materials. *Stone rubble*
 (c) Roofs. *Stone slates.*

3. Historical development (with dates and small sketch plan).

Probably a 16th c. house. Late in 17th or early 18th it was re-modelled & an addition built along the whole length of the N wall. In modern times this rear lean-to addition was heightened to 2 stories.

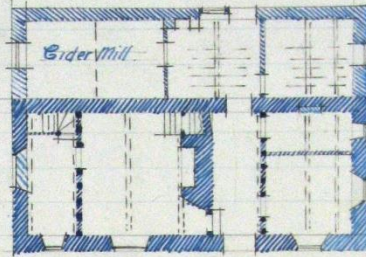

4. Special features (if any)

5. Elevations: (Beginning with the main front, and mentioning, in the following order:—(a) Walls; (b) Gables; (c) Doors; (d) Windows; (e) Chimneys; (f) Rainwater heads and pipes.)

- S. Elev. Rubble. Entrance door has moulded wood frame.*
- E. Elev. Gabled. Exposed timbers. Rebuilt upper wall to rear addition. The wall is battered at base. Attic has old wood frame windows & also a slit window. Stack has been rebuilt.*
- N. Elev. Rubble. Upper part of wall re-built re-roofed.*
- W. Elev. Gabled. Blocked window on ground floor. Wall re-built in upper half of rear addition.*

6. Grounds: (



7. Interior: (Disposition of rooms, if original, giving fittings as they occur (see list), beginning with the ground floor, following with the basement, and working up to the attics; staircases in the same manner.)

Fittings:

(Reminder list).

(1) Ceilings

(2) Cupboards (fixed).

(3) Doors and Overdoors.

(4) Fireplaces and Mantel-pieces.

(5) Glass.

(6) Paintings.

(7) Panelling.

(8) Parquetry and floors.

(9) Plasterwork on internal walls.

(10) Roofs and beams (internal).

(11) Screens.

(12) Tapestries.

(13) Miscellaneous (e.g., carving, ironwork, locks, &c.).

There is a chamfered door frame between hall & west room.

Entrance to staircase (stone stairs) against central stack has battened door (17 $\frac{1}{2}$ c.) hung on pair of traps hinges.

There are also on this floor 4 plain battened doors of c. 17 $\frac{1}{2}$ hung on strap hinges.

On 1st floor are two battened doors with moulded planks

Cupboard in bedroom has for doors some re-used 17 $\frac{1}{2}$ c. moulded panelling the rails being enriched with carved channelling.

In dairy are pair of battened interior window shutters hung on strap hinges.

Ceilings of ground floor rooms all have step chamfered beams, that in ground floor room w. traps having 'spur' stops while these are either plain or moulded stops.

Joints are exposed in rear addition & in mud w. room.

8. Condition: Good.

9. Visited by (with dates): A.T. Phillips, May 1927.

10. Bibliography:

11. No. of Ordnance Sheet (6-in.): XLIII. N.E.

12. Signature of Investigator: A.T. Phillips

